

Parts

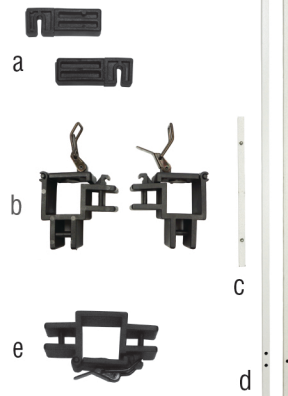

- a. Side Rail End Hooks
 - b. Side Rail End Brackets
 - c. Side Rail Middle Connector Bar
 - d. Side Rail Bars
 - e. Side Rail Middle Bracket
- *only needed for 20' Side Rail

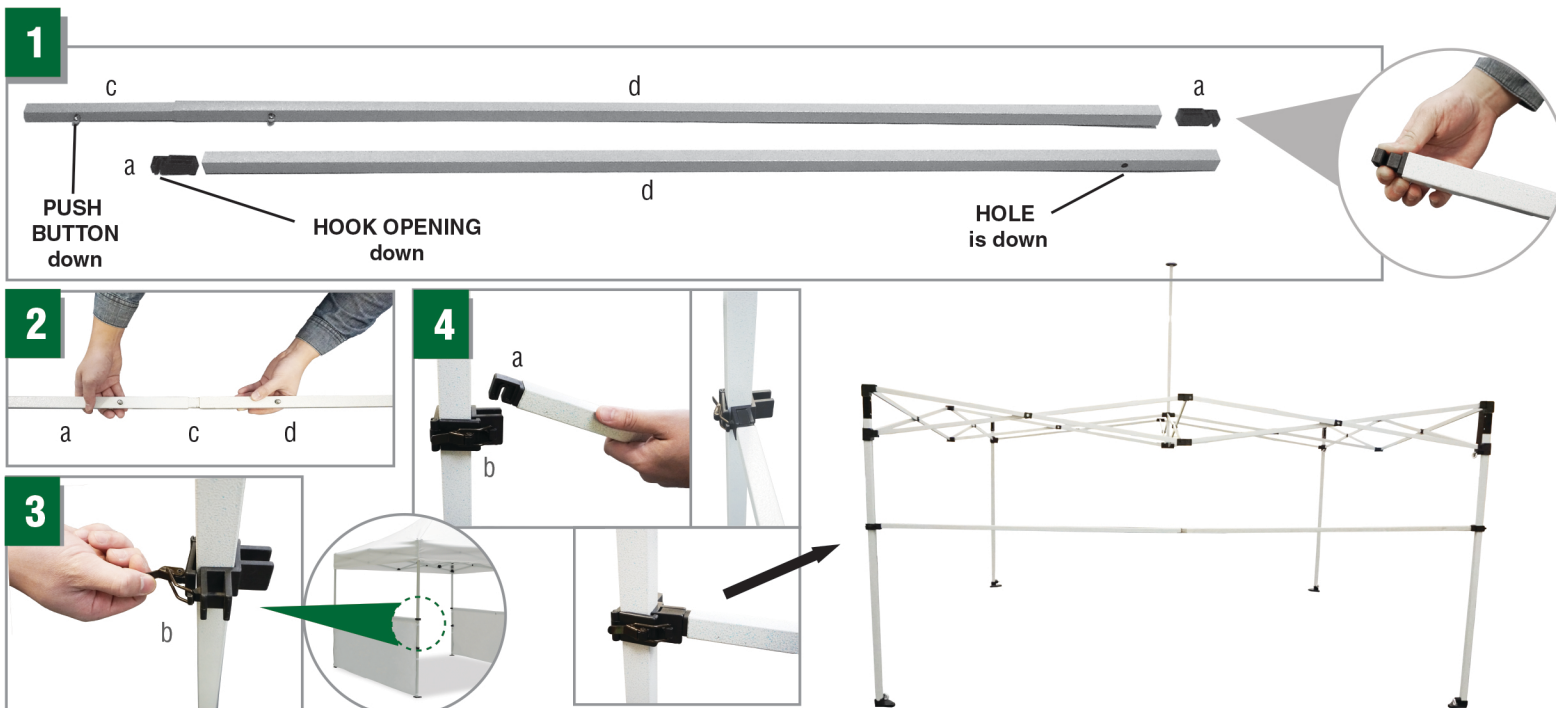

10' Side Rail

Lay out all parts. Parts needed for 10' side rail: (a), 2 Side Rail End Brackets (b), 1 Side Rail Middle Connector (c) and 2 Side Rail Bars (d).

① Insert the Side Rail end Hook (a) into the Side Rail Bar (d) into the end furthest away from the hole. Also make sure the hook opening and hole are facing downward. Do this for both Side End Hooks (a) and Side Rail Bars (d).

② Connecting the Side Rail Bars (d) by aligning the Push-Button on the Middle Connector (c) with the hole on the Side Rail Bar (d). Slide the Middle Connector (c) into the Side Rail Bar (d), pushing down the push-button until it locks into the hole on the Side Rail Bar (d).

Slide all the connected pieces (a)+(d)+(c)+(d)+(a) through the Side Rail Fabric channel.

③ Open the 2 Side Rail End Brackets (b) and attach to the Legs of the Caravan Canopy. Then hook the Side Rail End Brackets (b) into the Side Rail End Hooks (a) which are already attached to each side of the Side Rail Bars (d).

The last step is to put the hook and loop straps from the Side Rail Fabric around the Caravan Canopy Legs.

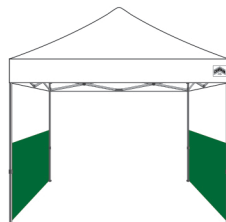

15' Side Rail

Parts needed for 15' side rail: 2 Side Rail End Hooks (a), 2 Side Rail End Brackets (b), 2 Side Rail Middle Connector (c) and 3 Side Rail Bars (d).

Assemble (a)+(d)+(c)+(d)+(c)+(d)+(a) and Slide all the connected pieces through the Side Rail Fabric channel. Then hook the Side Rail End Brackets (b) into the Side Rail End Hooks (a) who are already attached to each side of the Side Rail Bars (d). Side Rail End Brackets (b) connects everything with the Caravan Canopy Legs. The last step is to put the hook and loop straps around both legs.



20' Side Rail

Parts needed for 20' side rail: 4 Side Rail End Hooks (a), 2 Side Rail End Brackets (b), 1 Side Rail Middle Bracket (e), 2 Side Rail Middle Connector (c) and 4 Side Rail Bars (d).

Assemble 2 10' Side Rail* with Side Rail Fabric and then connect both pieces with the Side Rail Middle Bracket (e). See Assembling Picture 4. Before you go any further check if you connected these parts with each other (a) + (d) + (c) + (d) + (a) + (e) + (a) + (d) + (c) + (d) + (a).

Open the Side Rail Middle Bracket (e) and connect the middle Leg of the 20' Side Rail. Finally put the hook and loop Straps around the Side Rail Middle Leg and the corner Legs of the Caravan Canopy. If you have any question please contact us for further instructions.

